

IAG

INTERIOR ARCHITECTURE GROUP

TOP CONTEMPORARY

INTERIORS

NEW TRENDS IN INDIAN RESIDENTIAL SPACES

RESIDENCES

CONTENTS

240 AZALEA APARTMENT

Bengaluru, Karnataka, India
FADD Studio, Bengaluru, Karnataka, India

248 GUPTA RESIDENCE

Mumbai, Maharashtra, India
Amit Shastri Architect & Interior Designer, Mumbai, Maharashtra, India

256 KHENI'S RESIDENCE

Ahmedabad, Gujarat, India
Adda Architects & Urban Designers, Surat, Gujarat, India

268 MAISON—A FAMILY THAT LIVES TOGETHER

Mumbai, Maharashtra, India
Open Atelier Mumbai, Mumbai, Maharashtra, India

278 LOOMBA HOUSE

Mumbai, Maharashtra, India
Navin Nisar Design, Mumbai, Maharashtra, India

284 TRIPLEX APARTMENT

Nashik, Maharashtra, India
The BNK Group, Mumbai

300 SHUBHA RESIDENCE

Bengaluru, Karnataka, India
SASW, Bengaluru, Karnataka, India

308 VIEW FROM THE TOP

Mumbai, Maharashtra, India
Saima Salam Design, Mumbai, Maharashtra, India

316 AGARWAL'S RESIDENCY

Surat, Gujarat, India
Design Core, Surat, Gujarat, India

327 ACKNOWLEDGEMENTS

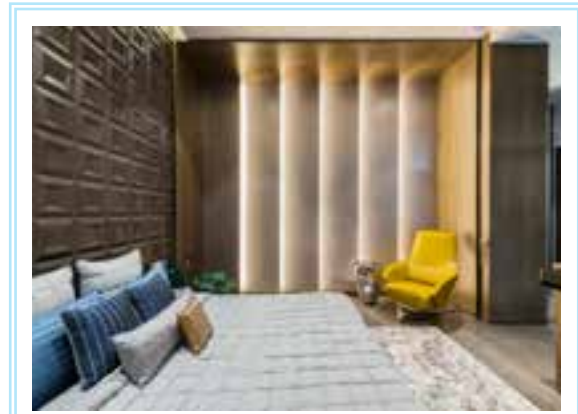

CONTEMPORARY STYLE

The language adopted for the interiors speaks of an elegant and minimal home with a strong hint of geometry and function.



Amit Shastri Architects
Architecture | Interior

Amit Shastri Architect & Interior Designer

Location: Mumbai, Maharashtra, India
Website: www.amitshastriarchitects.com
Principal Architect: Ar. Amit Shastri
Design Team: Amit Shastri & Hajra Shaikh

COMPANY PROFILE

In 2001, architect Amit Shastri established Amit Shastri Architect & Interior Designer in Mumbai, engaging in and focused on de-constructing the complexities of a thought process and translating them into simple, elegant design solutions. With an intimate involvement with the client and a continuous endeavor for achieving excellence, the firm functions as a studio practice, with a compact team and tight-knit dynamics.

The firm's aim is to carefully understand the client's requirements and establish a connect between the occupant and his space. Eschewing a specialization or a signature, the firm believes in lending its expertise to a variety of projects: residential complexes, villas, office/home interiors, commercial buildings, educational institutes, multi-utility/multifunctional industrial planning and many more.

GUPTA RESIDENCE

Client Name- Mr. Sushil Gupta, Project Location- Mumbai, Maharashtra, India, Built up Area- 340 sq. mtr., Photography Credit- Photographix -Sebastian Zachariah

OVERVIEW

The 4BHK apartment project had a precise brief: the owners were a couple with two daughters who were in the fashion industry and one son who was in school. They wanted a modern, contemporary space, which would be easy to maintain, felt like a cozy home and yet had unique elements to make it stand apart.

The spatial program evolved after studying the lifestyles and habits of the couple and their children in detail. The intent was to create a design mark while optimizing the function of the space. The apartment only needed to be styled with furniture and embellishments, but the architects had a concept that worked on maximizing the view which needed them to demolish the current layout. Function and panoramic green view drove the design towards a comfortable decor with neutral colours featuring wood, veneer with natural polish and Italian marble. The living room opened onto the panoramic views of the city via the balcony while the dining space was an intimate space for family gatherings. The bedrooms were designed to reflect the personalities of those inhabiting the spaces. Overall the spatial language of the residence could be defined as elegant and minimal with quirky elements interspersed throughout the space.



The living room with mushroom leather seating and dining with highlights of rust leather on chairs, wallpaper and niches inset with soft lighting celebrates the length of 25 feet balcony facing the panoramic green Aarey greens.

The dining corner in wood, leather, steel and linear light flow is the space where the family unites over meals and laughter.



The master bedroom of this 4BHK apartment, predominantly in a demure neutral pantone, is highlighted with lined wallpaper from Belgium that complements the mango onyx and cracked veneer headrest.



The bed, planned off centre to the headrest, renders the quiet decor with a little bit of twist.

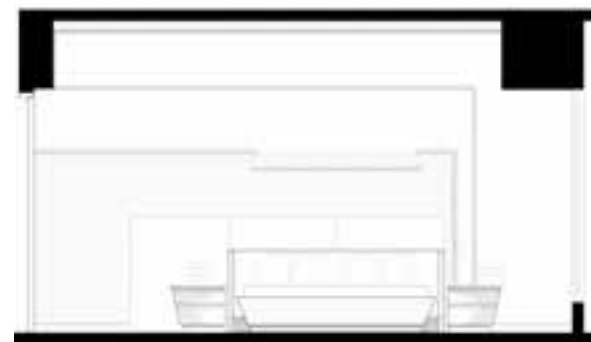

MASTER BEDROOM DETAIL



The bold youthful spirit of the son's room is communicated through skewed lines embedded with strips of continuous LED lights. Folds of origami in the ceiling and skewed lines infuse the study corner in the son's bedroom with vibrancy, while the strategic installation of a large mirror attributes it with snug exclusivity.



SECTIONAL ELEVATION AA



SECTIONAL DETAILS

SECTIONAL ELEVATION BB



KEY PLAN



The space belonging to the younger sister was designed with demure pastels and a winged leather headboard to reflect the personality of a budding fashion designer and model.

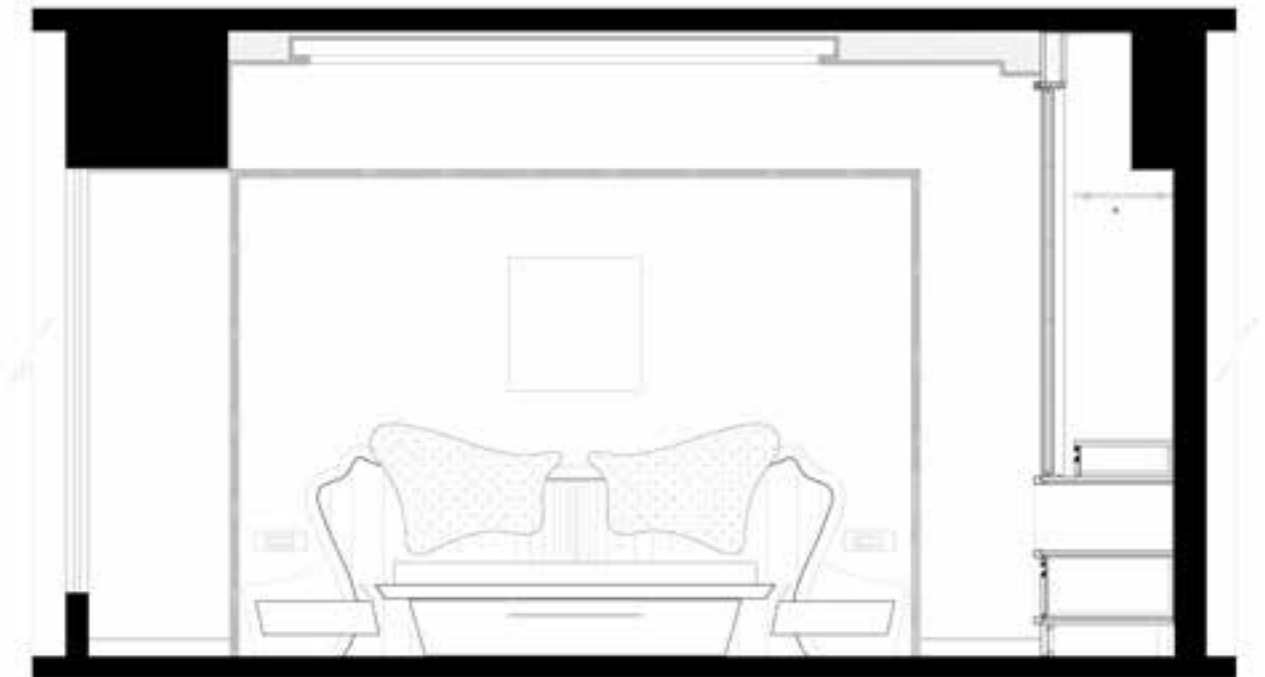

BEDROOM DETAIL



The elder sister's room adorns a rustic charm with wood and metal. Copper sheet backdrop and Corbusier Dot series wallpaper from arte, complement the solid wooden side tables with copper base to highlight this elegance.



A leather writing desk, leather carpet, and a chair from Cecco add sleek grace, while the wardrobe with cracked wooden door, solid copper handles complements the design.



The exclusive dressing area was designed with detailing for storage, shoes, bags, accessories and a well-lit, stylish, full-length mirror for a walk-in vanity space.



The washroom adjoining the room borrows from its elegance and style and is developed in the room's general theme.



GROUND FLOOR PLAN



LEGEND

GROUND FLOOR PLAN

- 1. ENTRANCE OUTDOOR PASSAGE
- 2. MAIN ENTRANCE INTERNAL PASSAGE
- 3. LIVING ROOM
- 4. ATT. BALCONY
- 5. DINING
- 6. KITCHEN
- 7. WASH AREA
- 8. WALKWAY
- 9. SON'S BEDROOM
- 10. BATHROOM
- 11. MASTER BEDROOM

- 12. DRESSING
- 13. BATHROOM
- 14. WALKWAY
- 15. POWDER ROOM
- 16. ELDER DAUGHTER'S BEDROOM
- 17. YOUNGER DAUGHTER'S BEDROOM
- 18. DRESSING
- 19. BATHROOM
- 20. SERVANT'S ROOM

MATERIALS

- Flooring: Golden Spider Italian Marble
- Wall Cladding: Mango Onyx, Rest Rooms: Black Marquina, Armani Brown, Classic White, Gray Fresco (Italian Marble)
- Interior Finishes: Wall Paint – Asian paints
- Light Fixtures: Hybec, Havells, Arteor
- Kitchen: Siemens Appliances
- Bath Fixtures: Jaquar, Duravit
- Furniture/Decor: Stanley leather sofas- India, BAM- China, DEFURN furniture studio; ARTE wall papers- Belgium, pride furnishings, Cecco- China, Paintings & artefacts: assorted
- Others: Customised Elements- stainless steel & copper (areas- doors, hardware, ceiling, dining, wall cladding) & cladding in black, brown, pink mirrors